

SPB INDUSTRIAL CO.,LIMITED

Web: <http://www.spboiles.com>

Email: zhou@spboiles.com

PE-S(DU) Cylinder Bushing Catalog

- STRUCTURE

Metal-Polymer Composite Bushing Material

- CHARACTERISTICS

1. DU self-lubricating bushings offer very good wear and low friction performance over a wide range of loads, speeds and temperatures in dry running conditions
2. Suitable for lubricated applications
3. Suitable for linear, oscillating and rotating movements

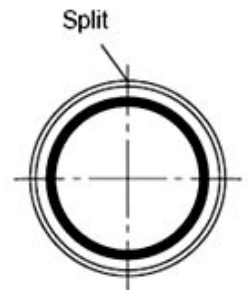
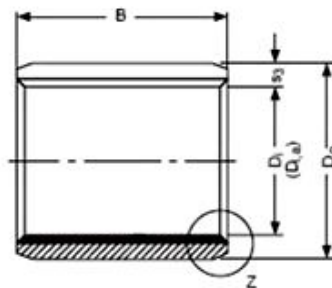
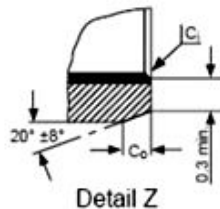

Metric Sizes:

Part No.	Di (mm)	Do (mm)	B (mm)	Housing	Shaft	Di,a max in H7 (mm)	Di,a min in H7 (mm)	Clearance max. (mm)	Clearance min. (mm)
0203DU	2	3.5	3	H6	h6	2.048	2	0.054	0
0205DU	2	3.5	5	H6	h6	2.048	2	0.054	0
0303DU	3	4.5	3	H6	h6	3.048	3	0.054	0
0305DU	3	4.5	5	H6	h6	3.048	3	0.054	0
0306DU	3	4.5	6	H6	h6	3.048	3	0.054	0
0403DU	4	5.5	3	H6	h6	4.048	4	0.056	0
0404DU	4	5.5	4	H6	h6	4.048	4	0.056	0
0406DU	4	5.5	6	H6	h6	4.048	4	0.056	0
0410DU	4	5.5	10	H6	h6	4.048	4	0.056	0
0505DU	5	7	5	H7	f7	5.055	4.99	0.077	0
0508DU	5	7	8	H7	f7	5.055	4.99	0.077	0
0510DU	5	7	10	H7	f7	5.055	4.99	0.077	0
0604DU	6	8	4	H7	f7	6.055	5.99	0.077	0
0606DU	6	8	6	H7	f7	6.055	5.99	0.077	0
0608DU	6	8	8	H7	f7	6.055	5.99	0.077	0
0610DU	6	8	10	H7	f7	6.055	5.99	0.077	0

SPB INDUSTRIAL CO.,LIMITED

Web: <http://www.spboiles.com>

Email: zhou@spboiles.com

0705DU	7	9	5	H7	f7	7.055	6.99	0.083	0.003
0710DU	7	9	10	H7	f7	7.055	6.99	0.083	0.003
0806DU	8	10	6	H7	f7	8.055	7.99	0.083	0.003
0808DU	8	10	8	H7	f7	8.055	7.99	0.083	0.003
0810DU	8	10	10	H7	f7	8.055	7.99	0.083	0.003
0812DU	8	10	12	H7	f7	8.055	7.99	0.083	0.003
1006DU	10	12	6	H7	f7	10.058	9.99	0.086	0.003
1008DU	10	12	8	H7	f7	10.058	9.99	0.086	0.003
1010DU	10	12	10	H7	f7	10.058	9.99	0.086	0.003
1012DU	10	12	12	H7	f7	10.058	9.99	0.086	0.003
1015DU	10	12	15	H7	f7	10.058	9.99	0.086	0.003
1020DU	10	12	20	H7	f7	10.058	9.99	0.086	0.003
1208DU	12	14	8	H7	f7	12.058	11.99	0.092	0.006
1210DU	12	14	10	H7	f7	12.058	11.99	0.092	0.006
1212DU	12	14	12	H7	f7	12.058	11.99	0.092	0.006
1215DU	12	14	15	H7	f7	12.058	11.99	0.092	0.006
1220DU	12	14	20	H7	f7	12.058	11.99	0.092	0.006
1225DU	12	14	25	H7	f7	12.058	11.99	0.092	0.006
1310DU	13	15	10	H7	f7	13.058	12.99	0.092	0.006
1320DU	13	15	20	H7	f7	13.058	12.99	0.092	0.006
1405DU	14	16	5	H7	f7	14.058	13.99	0.092	0.006
1410DU	14	16	10	H7	f7	14.058	13.99	0.092	0.006
1412DU	14	16	12	H7	f7	14.058	13.99	0.092	0.006
1415DU	14	16	15	H7	f7	14.058	13.99	0.092	0.006
1420DU	14	16	20	H7	f7	14.058	13.99	0.092	0.006
1425DU	14	16	25	H7	f7	14.058	13.99	0.092	0.006
1510DU	15	17	10	H7	f7	15.058	14.99	0.092	0.006
1512DU	15	17	12	H7	f7	15.058	14.99	0.092	0.006
1515DU	15	17	15	H7	f7	15.058	14.99	0.092	0.006
1520DU	15	17	20	H7	f7	15.058	14.99	0.092	0.006
1525DU	15	17	25	H7	f7	15.058	14.99	0.092	0.006
1610DU	16	18	10	H7	f7	16.058	15.99	0.092	0.006
1612DU	16	18	12	H7	f7	16.058	15.99	0.092	0.006
1615DU	16	18	15	H7	f7	16.058	15.99	0.092	0.006
1620DU	16	18	20	H7	f7	16.058	15.99	0.092	0.006
1625DU	16	18	25	H7	f7	16.058	15.99	0.092	0.006
1720DU	17	19	20	H7	f7	17.061	16.99	0.095	0.006
1810DU	18	20	10	H7	f7	18.061	17.99	0.095	0.006
1815DU	18	20	15	H7	f7	18.061	17.99	0.095	0.006
1820DU	18	20	20	H7	f7	18.061	17.99	0.095	0.006

SPB INDUSTRIAL CO.,LIMITED

Web: <http://www.spboiles.com>

Email: zhou@spboiles.com

1825DU	18	20	25	H7	f7	18.061	17.99	0.095	0.006
2010DU	20	23	10	H7	f7	20.071	19.99	0.112	0.01
2015DU	20	23	15	H7	f7	20.071	19.99	0.112	0.01
2020DU	20	23	20	H7	f7	20.071	19.99	0.112	0.01
2025DU	20	23	25	H7	f7	20.071	19.99	0.112	0.01
2030DU	20	23	30	H7	f7	20.071	19.99	0.112	0.01
2215DU	22	25	15	H7	f7	22.071	21.99	0.112	0.01
2220DU	22	25	20	H7	f7	22.071	21.99	0.112	0.01
2225DU	22	25	25	H7	f7	22.071	21.99	0.112	0.01
2230DU	22	25	30	H7	f7	22.071	21.99	0.112	0.01
2415DU	24	27	15	H7	f7	24.071	23.99	0.112	0.01
2420DU	24	27	20	H7	f7	24.071	23.99	0.112	0.01
2425DU	24	27	25	H7	f7	24.071	23.99	0.112	0.01
2430DU	24	27	30	H7	f7	24.071	23.99	0.112	0.01
2515DU	25	28	15	H7	f7	25.071	24.99	0.112	0.01
2520DU	25	28	20	H7	f7	25.071	24.99	0.112	0.01
2525DU	25	28	25	H7	f7	25.071	24.99	0.112	0.01
2530DU	25	28	30	H7	f7	25.071	24.99	0.112	0.01
2550DU	25	28	50	H7	f7	25.071	24.99	0.112	0.01
2815DU	28	32	15	H7	f7	28.085	27.99	0.126	0.01
2820DU	28	32	20	H7	f7	28.085	27.99	0.126	0.01
2825DU	28	32	25	H7	f7	28.085	27.99	0.126	0.01
2830DU	28	32	30	H7	f7	28.085	27.99	0.126	0.01
3010DU	30	34	10	H7	f7	30.085	29.99	0.126	0.01
3015DU	30	34	15	H7	f7	30.085	29.99	0.126	0.01
3020DU	30	34	20	H7	f7	30.085	29.99	0.126	0.01
3025DU	30	34	25	H7	f7	30.085	29.99	0.126	0.01
3030DU	30	34	30	H7	f7	30.085	29.99	0.126	0.01
3040DU	30	34	40	H7	f7	30.085	29.99	0.126	0.01
3220DU	32	36	20	H7	f7	32.085	31.99	0.135	0.015
3230DU	32	36	30	H7	f7	32.085	31.99	0.135	0.015
3240DU	32	36	40	H7	f7	32.085	31.99	0.135	0.015
3520DU	35	39	20	H7	f7	35.085	34.99	0.135	0.015
3530DU	35	39	30	H7	f7	35.085	34.99	0.135	0.015
3535DU	35	39	35	H7	f7	35.085	34.99	0.135	0.015
3540DU	35	39	40	H7	f7	35.085	34.99	0.135	0.015
3550DU	35	39	50	H7	f7	35.085	34.99	0.135	0.015
3720DU	37	41	20	H7	f7	37.085	36.99	0.135	0.015
4020DU	40	44	20	H7	f7	40.085	39.99	0.135	0.015
4030DU	40	44	30	H7	f7	40.085	39.99	0.135	0.015

SPB INDUSTRIAL CO.,LIMITED

Web: <http://www.spboiles.com>

Email: zhou@spboiles.com

4040DU	40	44	40	H7	f7	40.085	39.99	0.135	0.015
4050DU	40	44	50	H7	f7	40.085	39.99	0.135	0.015
4520DU	45	50	20	H7	f7	45.105	44.99	0.155	0.015
4530DU	45	50	30	H7	f7	45.105	44.99	0.155	0.015
4540DU	45	50	40	H7	f7	45.105	44.99	0.155	0.015
4545DU	45	50	45	H7	f7	45.105	44.99	0.155	0.015
4550DU	45	50	50	H7	f7	45.105	44.99	0.155	0.015
5020DU	50	55	20	H7	f7	50.11	49.99	0.16	0.015
5030DU	50	55	30	H7	f7	50.11	49.99	0.16	0.015
5040DU	50	55	40	H7	f7	50.11	49.99	0.16	0.015
5050DU	50	55	50	H7	f7	50.11	49.99	0.16	0.015
5060DU	50	55	60	H7	f7	50.11	49.99	0.16	0.015
5520DU	55	60	20	H7	f7	55.11	54.99	0.17	0.02
5525DU	55	60	25	H7	f7	55.11	54.99	0.17	0.02
5530DU	55	60	30	H7	f7	55.11	54.99	0.17	0.02
5540DU	55	60	40	H7	f7	55.11	54.99	0.17	0.02
5550DU	55	60	50	H7	f7	55.11	54.99	0.17	0.02
5555DU	55	60	55	H7	f7	55.11	54.99	0.17	0.02
5560DU	55	60	60	H7	f7	55.11	54.99	0.17	0.02
6020DU	60	65	20	H7	f7	60.11	59.99	0.17	0.02
6030DU	60	65	30	H7	f7	60.11	59.99	0.17	0.02
6040DU	60	65	40	H7	f7	60.11	59.99	0.17	0.02
6050DU	60	65	50	H7	f7	60.11	59.99	0.17	0.02
6060DU	60	65	60	H7	f7	60.11	59.99	0.17	0.02
6070DU	60	65	70	H7	f7	60.11	59.99	0.17	0.02
6530DU	65	70	30	H7	f7	65.11	64.99	0.17	0.02
6550DU	65	70	50	H7	f7	65.11	64.99	0.17	0.02
6570DU	65	70	70	H7	f7	65.11	64.99	0.17	0.02
7040DU	70	75	40	H7	f7	70.11	69.99	0.17	0.02
7050DU	70	75	50	H7	f7	70.11	69.99	0.17	0.02
7070DU	70	75	70	H7	f7	70.11	69.99	0.17	0.02
7560DU	75	80	60	H7	f7	75.11	74.99	0.17	0.02
7580DU	75	80	80	H7	f7	75.11	74.99	0.17	0.02
8040DU	80	85	40	H7	h8	80.155	80.02	0.209	0.02
8060DU	80	85	60	H7	h8	80.155	80.02	0.209	0.02
8080DU	80	85	80	H7	h8	80.155	80.02	0.209	0.02
80100DU	80	85	100	H7	h8	80.155	80.02	0.209	0.02
8530DU	85	90	30	H7	h8	85.155	85.02	0.209	0.02
8560DU	85	90	60	H7	h8	85.155	85.02	0.209	0.02
85100DU	85	90	100	H7	h8	85.155	85.02	0.209	0.02

SPB INDUSTRIAL CO.,LIMITED

Web: <http://www.spboiles.com>

Email: zhou@spboiles.com

9060DU	90	95	60	H7	h8	90.155	90.02	0.209	0.02
90100DU	90	95	100	H7	h8	90.155	90.02	0.209	0.02
9560DU	95	100	60	H7	h8	95.155	95.02	0.209	0.02
95100DU	95	100	100	H7	h8	95.155	95.02	0.209	0.02
10050DU	100	105	50	H7	h8	100.155	100.02	0.209	0.02
10060DU	100	105	60	H7	h8	100.155	100.02	0.209	0.02
100115DU	100	105	115	H7	h8	100.155	100.02	0.209	0.02
10560DU	105	110	60	H7	h8	105.155	105.02	0.209	0.02
105115DU	105	110	115	H7	h8	105.155	105.02	0.209	0.02
11060DU	110	115	60	H7	h8	110.155	110.02	0.209	0.02
110115DU	110	115	115	H7	h8	110.155	110.02	0.209	0.02
11550DU	115	120	50	H7	h8	115.155	115.02	0.209	0.02
11570DU	115	120	70	H7	h8	115.155	115.02	0.209	0.02
12050DU	120	125	50	H7	h8	120.21	120.07	0.264	0.07
12060DU	120	125	60	H7	h8	120.21	120.07	0.264	0.07
120100DU	120	125	100	H7	h8	120.21	120.07	0.264	0.07
125100DU	125	130	100	H7	h8	125.21	125.07	0.273	0.07
13060DU	130	135	60	H7	h8	130.21	130.07	0.273	0.07
130100DU	130	135	100	H7	h8	130.21	130.07	0.273	0.07
13560DU	135	140	60	H7	h8	135.21	135.07	0.273	0.07
13580DU	135	140	80	H7	h8	135.21	135.07	0.273	0.07
14060DU	140	145	60	H7	h8	140.21	140.07	0.273	0.07
140100DU	140	145	100	H7	h8	140.21	140.07	0.273	0.07
15060DU	150	155	60	H7	h8	150.21	150.07	0.273	0.07
15080DU	150	155	80	H7	h8	150.21	150.07	0.273	0.07
150100DU	150	155	100	H7	h8	150.21	150.07	0.273	0.07
16080DU	160	165	80	H7	h8	160.21	160.07	0.273	0.07
160100DU	160	165	100	H7	h8	160.21	160.07	0.273	0.07
180100DU	180	185	100	H7	h8	180.216	180.07	0.279	0.07
200100DU	200	205	100	H7	h8	200.216	200.07	0.288	0.07
210100DU	210	215	100	H7	h8	210.216	210.07	0.288	0.07
220100DU	220	225	100	H7	h8	220.216	220.07	0.288	0.07
250100DU	250	255	100	H7	h8	250.222	250.07	0.294	0.07
300100DU	300	305	100	H7	h8	300.222	300.07	0.303	0.0

SPB INDUSTRIAL CO., LIMITED

Web: <http://www.spboiles.com>

Email: zhou@spboiles.com

Inch Size:

Part No.	Di [inch]	Do [inch]	B (inch)	DJ max. (inch)	DJ min. (inch)	DH max. (inch)	DH min. (inch)	Di,a max (inch)	Di,a min (inch)	Clearance max. (inch)	Clearance min. (inch)
02DU02	1/8	3/16	0.125	0.1243	0.1236	0.1878	0.1873	0.1268	0.1243	0.0032	0
02DU03	1/8	3/16	0.188	0.1243	0.1236	0.1878	0.1873	0.1268	0.1243	0.0032	0
025DU025	5/32	7/32	0.154	0.1554	0.1547	0.2191	0.2186	0.1581	0.1556	0.0034	0.0002
025DU04	5/32	7/32	0.25	0.1554	0.1547	0.2191	0.2186	0.1581	0.1556	0.0034	0.0002
03DU03	3/16	1/4	0.188	0.1865	0.1858	0.2503	0.2497	0.1893	0.1867	0.0035	0.0002
03DU04	3/16	1/4	0.25	0.1865	0.1858	0.2503	0.2497	0.1893	0.1867	0.0035	0.0002
03DU06	3/16	1/4	0.375	0.1865	0.1858	0.2503	0.2497	0.1893	0.1867	0.0035	0.0002
04DU04	1/4	5/16	0.25	0.249	0.2481	0.3128	0.3122	0.2518	0.2492	0.0037	0.0002
04DU06	1/4	5/16	0.375	0.249	0.2481	0.3128	0.3122	0.2518	0.2492	0.0037	0.0002
05DU06	5/16	3/8	0.375	0.3115	0.3106	0.3753	0.3747	0.3143	0.3117	0.0037	0.0002
05DU08	5/16	3/8	0.5	0.3115	0.3106	0.3753	0.3747	0.3143	0.3117	0.0037	0.0002
06DU03	3/8	15/32	0.188	0.374	0.3731	0.4691	0.4684	0.3769	0.3742	0.0038	0.0002
06DU04	3/8	15/32	0.25	0.374	0.3731	0.4691	0.4684	0.3769	0.3742	0.0038	0.0002
06DU06	3/8	15/32	0.375	0.374	0.3731	0.4691	0.4684	0.3769	0.3742	0.0038	0.0002
06DU08	3/8	15/32	0.5	0.374	0.3731	0.4691	0.4684	0.3769	0.3742	0.0038	0.0002
06DU10	3/8	15/32	0.625	0.374	0.3731	0.4691	0.4684	0.3769	0.3742	0.0038	0.0002
06DU12	3/8	15/32	0.75	0.374	0.3731	0.4691	0.4684	0.3769	0.3742	0.0038	0.0002
07DU08	7/16	17/32	0.5	0.4365	0.4355	0.5316	0.5309	0.4394	0.4367	0.0039	0.0002
07DU12	7/16	17/32	0.75	0.4365	0.4355	0.5316	0.5309	0.4394	0.4367	0.0039	0.0002
08DU04	1/2	19/32	0.25	0.499	0.498	0.5941	0.5934	0.5019	0.4992	0.0039	0.0002
08DU06	1/2	19/32	0.375	0.499	0.498	0.5941	0.5934	0.5019	0.4992	0.0039	0.0002
08DU08	1/2	19/32	0.5	0.499	0.498	0.5941	0.5934	0.5019	0.4992	0.0039	0.0002
08DU10	1/2	19/32	0.625	0.499	0.498	0.5941	0.5934	0.5019	0.4992	0.0039	0.0002
08DU12	1/2	19/32	0.75	0.499	0.498	0.5941	0.5934	0.5019	0.4992	0.0039	0.0002
08DU14	1/2	19/32	0.875	0.499	0.498	0.5941	0.5934	0.5019	0.4992	0.0039	0.0002
09DU06	9/16	21/32	0.375	0.5615	0.5605	0.6566	0.6559	0.5644	0.5617	0.0039	0.0002
09DU08	9/16	21/32	0.5	0.5615	0.5605	0.6566	0.6559	0.5644	0.5617	0.0039	0.0002
09DU10	9/16	21/32	0.625	0.5615	0.5605	0.6566	0.6559	0.5644	0.5617	0.0039	0.0002
09DU12	9/16	21/32	0.75	0.5615	0.5605	0.6566	0.6559	0.5644	0.5617	0.0039	0.0002
10DU04	5/8	23/32	0.25	0.624	0.623	0.7192	0.7184	0.627	0.6242	0.004	0.0002
10DU08	5/8	23/32	0.5	0.624	0.623	0.7192	0.7184	0.627	0.6242	0.004	0.0002
10DU10	5/8	23/32	0.625	0.624	0.623	0.7192	0.7184	0.627	0.6242	0.004	0.0002
10DU12	5/8	23/32	0.75	0.624	0.623	0.7192	0.7184	0.627	0.6242	0.004	0.0002
10DU14	5/8	23/32	0.875	0.624	0.623	0.7192	0.7184	0.627	0.6242	0.004	0.0002
10DU16	5/8	23/32	1	0.624	0.623	0.7192	0.7184	0.627	0.6242	0.004	0.0002

SPB INDUSTRIAL CO.,LIMITED

Web: <http://www.spboiles.com>

Email: zhou@spboiles.com

11DU14	11/16	25/32	0.875	0.6865	0.6855	0.7817	0.7809	0.6895	0.6867	0.004	0.0002
12DU04	3/4	7/8	0.25	0.7491	0.7479	0.8755	0.8747	0.7525	0.7493	0.0046	0.0002
12DU06	3/4	7/8	0.375	0.7491	0.7479	0.8755	0.8747	0.7525	0.7493	0.0046	0.0002
12DU08	3/4	7/8	0.5	0.7491	0.7479	0.8755	0.8747	0.7525	0.7493	0.0046	0.0002
12DU10	3/4	7/8	0.625	0.7491	0.7479	0.8755	0.8747	0.7525	0.7493	0.0046	0.0002
12DU12	3/4	7/8	0.75	0.7491	0.7479	0.8755	0.8747	0.7525	0.7493	0.0046	0.0002
12DU16	3/4	7/8	1	0.7491	0.7479	0.8755	0.8747	0.7525	0.7493	0.0046	0.0002
14DU04	7/8	1	0.25	0.8741	0.8729	1.0005	0.9997	0.8775	0.8743	0.0046	0.0002
14DU06	7/8	1	0.375	0.8741	0.8729	1.0005	0.9997	0.8775	0.8743	0.0046	0.0002
14DU12	7/8	1	0.75	0.8741	0.8729	1.0005	0.9997	0.8775	0.8743	0.0046	0.0002
14DU14	7/8	1	0.875	0.8741	0.8729	1.0005	0.9997	0.8775	0.8743	0.0046	0.0002
14DU16	7/8	1	1	0.8741	0.8729	1.0005	0.9997	0.8775	0.8743	0.0046	0.0002
14DU20	7/8	1	1.25	0.8741	0.8729	1.0005	0.9997	0.8775	0.8743	0.0046	0.0002
16DU06	1	1 1/8	0.375	0.9991	0.9979	1.1256	1.1246	1.0026	0.9992	0.0047	0.0001
16DU08	1	1 1/8	0.5	0.9991	0.9979	1.1256	1.1246	1.0026	0.9992	0.0047	0.0001
16DU12	1	1 1/8	0.75	0.9991	0.9979	1.1256	1.1246	1.0026	0.9992	0.0047	0.0001
16DU16	1	1 1/8	1	0.9991	0.9979	1.1256	1.1246	1.0026	0.9992	0.0047	0.0001
16DU20	1	1 1/8	1.25	0.9991	0.9979	1.1256	1.1246	1.0026	0.9992	0.0047	0.0001
16DU24	1	1 1/8	1.5	0.9991	0.9979	1.1256	1.1246	1.0026	0.9992	0.0047	0.0001
18DU06	1 1/8	1 9/32	0.375	1.1238	1.1226	1.2818	1.2808	1.1278	1.124	0.0052	0.0002
18DU10	1 1/8	1 9/32	0.625	1.1238	1.1226	1.2818	1.2808	1.1278	1.124	0.0052	0.0002
18DU12	1 1/8	1 9/32	0.75	1.1238	1.1226	1.2818	1.2808	1.1278	1.124	0.0052	0.0002
18DU16	1 1/8	1 9/32	1	1.1238	1.1226	1.2818	1.2808	1.1278	1.124	0.0052	0.0002
20DU06	1 1/4	1 13/32	0.375	1.2488	1.2472	1.4068	1.4058	1.2528	1.249	0.0056	0.0002
20DU12	1 1/4	1 13/32	0.75	1.2488	1.2472	1.4068	1.4058	1.2528	1.249	0.0056	0.0002
20DU14	1 1/4	1 13/32	0.875	1.2488	1.2472	1.4068	1.4058	1.2528	1.249	0.0056	0.0002
20DU16	1 1/4	1 13/32	1	1.2488	1.2472	1.4068	1.4058	1.2528	1.249	0.0056	0.0002
20DU20	1 1/4	1 13/32	1.25	1.2488	1.2472	1.4068	1.4058	1.2528	1.249	0.0056	0.0002
20DU28	1 1/4	1 13/32	1.75	1.2488	1.2472	1.4068	1.4058	1.2528	1.249	0.0056	0.0002
22DU12	1 3/8	1 17/32	0.75	1.3738	1.3722	1.5318	1.5308	1.3778	1.374	0.0056	0.0002
22DU16	1 3/8	1 17/32	1	1.3738	1.3722	1.5318	1.5308	1.3778	1.374	0.0056	0.0002
22DU24	1 3/8	1 17/32	1.5	1.3738	1.3722	1.5318	1.5308	1.3778	1.374	0.0056	0.0002
22DU28	1 3/8	1 17/32	1.75	1.3738	1.3722	1.5318	1.5308	1.3778	1.374	0.0056	0.0002
24DU08	1 1/2	1 21/32	0.5	1.4988	1.4972	1.6568	1.6558	1.5028	1.499	0.0056	0.0002
24DU16	1 1/2	1 21/32	1	1.4988	1.4972	1.6568	1.6558	1.5028	1.499	0.0056	0.0002
24DU18	1 1/2	1 21/32	1.125	1.4988	1.4972	1.6568	1.6558	1.5028	1.499	0.0056	0.0002
24DU20	1 1/2	1 21/32	1.25	1.4988	1.4972	1.6568	1.6558	1.5028	1.499	0.0056	0.0002
24DU24	1 1/2	1 21/32	1.5	1.4988	1.4972	1.6568	1.6558	1.5028	1.499	0.0056	0.0002
24DU32	1 1/2	1 21/32	2	1.4988	1.4972	1.6568	1.6558	1.5028	1.499	0.0056	0.0002
26DU16	1 5/8	1 25/32	1	1.6238	1.6222	1.7818	1.7808	1.6278	1.624	0.0056	0.0002

SPB INDUSTRIAL CO., LIMITED

Web: <http://www.spboiles.com>

Email: zhou@spboiles.com

26DU24	1 5/8	1 25/32	1.5	1.6238	1.6222	1.7818	1.7808	1.6278	1.624	0.0056	0.0002
28DU16	1 3/4	1 15/16	1	1.7487	1.7471	1.9381	1.9371	1.7535	1.7489	0.0064	0.0002
28DU24	1 3/4	1 15/16	1.5	1.7487	1.7471	1.9381	1.9371	1.7535	1.7489	0.0064	0.0002
28DU28	1 3/4	1 15/16	1.75	1.7487	1.7471	1.9381	1.9371	1.7535	1.7489	0.0064	0.0002
28DU32	1 3/4	1 15/16	2	1.7487	1.7471	1.9381	1.9371	1.7535	1.7489	0.0064	0.0002
30DU12	1 7/8	2 1/16	0.75	1.8737	1.8721	2.0633	2.0621	1.8787	1.8739	0.0066	0.0002
30DU16	1 7/8	2 1/16	1	1.8737	1.8721	2.0633	2.0621	1.8787	1.8739	0.0066	0.0002
30DU30	1 7/8	2 1/16	1.875	1.8737	1.8721	2.0633	2.0621	1.8787	1.8739	0.0066	0.0002
30DU36	1 7/8	2 1/16	2.25	1.8737	1.8721	2.0633	2.0621	1.8787	1.8739	0.0066	0.0002
32DU08	2	2 3/16	0.5	1.9987	1.9969	2.1883	2.1871	2.0037	1.9989	0.0068	0.0002
32DU16	2	2 3/16	1	1.9987	1.9969	2.1883	2.1871	2.0037	1.9989	0.0068	0.0002
32DU24	2	2 3/16	1.5	1.9987	1.9969	2.1883	2.1871	2.0037	1.9989	0.0068	0.0002
32DU28	2	2 3/16	1.75	1.9987	1.9969	2.1883	2.1871	2.0037	1.9989	0.0068	0.0002
32DU32	2	2 3/16	2	1.9987	1.9969	2.1883	2.1871	2.0037	1.9989	0.0068	0.0002
32DU40	2	2 3/16	2.5	1.9987	1.9969	2.1883	2.1871	2.0037	1.9989	0.0068	0.0002
34DU08	2 1/8	2 5/16	0.5	2.1257	2.1239	2.313	2.3118	2.1326	2.1262	0.0087	0.0002
34DU12	2 1/8	2 5/16	0.75	2.1257	2.1239	2.313	2.3118	2.1326	2.1262	0.0087	0.0002
34DU16	2 1/8	2 5/16	1	2.1257	2.1239	2.313	2.3118	2.1326	2.1262	0.0087	0.0002
34DU24	2 1/8	2 5/16	1.5	2.1257	2.1239	2.313	2.3118	2.1326	2.1262	0.0087	0.0002
34DU28	2 1/8	2 5/16	1.75	2.1257	2.1239	2.313	2.3118	2.1326	2.1262	0.0087	0.0002
34DU32	2 1/8	2 5/16	2	2.1257	2.1239	2.313	2.3118	2.1326	2.1262	0.0087	0.0002
34DU48	2 1/8	2 5/16	3	2.1257	2.1239	2.313	2.3118	2.1326	2.1262	0.0087	0.0002
34DU64	2 1/8	2 5/16	4	2.1257	2.1239	2.313	2.3118	2.1326	2.1262	0.0087	0.0002
36DU28	2 1/4	2 7/16	1.75	2.2507	2.2489	2.4377	2.4365	2.2573	2.2509	0.0084	0.0002
36DU32	2 1/4	2 7/16	1.75	2.2507	2.2489	2.4377	2.4365	2.2573	2.2509	0.0084	0.0002
36DU36	2 1/4	2 7/16	2.25	2.2507	2.2489	2.4377	2.4365	2.2573	2.2509	0.0084	0.0002
36DU40	2 1/4	2 7/16	2.5	2.2507	2.2489	2.4377	2.4365	2.2573	2.2509	0.0084	0.0002
36DU48	2 1/4	2 7/16	3	2.2507	2.2489	2.4377	2.4365	2.2573	2.2509	0.0084	0.0002
36DU56	2 1/4	2 7/16	3.5	2.2507	2.2489	2.4377	2.4365	2.2573	2.2509	0.0084	0.0002
36DU60	2 1/4	2 7/16	3.75	2.2507	2.2489	2.4377	2.4365	2.2573	2.2509	0.0084	0.0002
36DU64	2 1/4	2 7/16	4	2.2507	2.2489	2.4377	2.4365	2.2573	2.2509	0.0084	0.0002
36DU72	2 1/4	2 7/16	4.5	2.2507	2.2489	2.4377	2.4365	2.2573	2.2509	0.0084	0.0002
40DU16	2 1/2	2 11/16	1	2.5011	2.4993	2.6881	2.6869	2.5077	2.5013	0.0084	0.0002
40DU26	2 1/2	2 11/16	1.625	2.5011	2.4993	2.6881	2.6869	2.5077	2.5013	0.0084	0.0002
40DU32	2 1/2	2 11/16	2	2.5011	2.4993	2.6881	2.6869	2.5077	2.5013	0.0084	0.0002
40DU40	2 1/2	2 11/16	2.5	2.5011	2.4993	2.6881	2.6869	2.5077	2.5013	0.0084	0.0002
40DU48	2 1/2	2 11/16	3	2.5011	2.4993	2.6881	2.6869	2.5077	2.5013	0.0084	0.0002
40DU56	2 1/2	2 11/16	3.5	2.5011	2.4993	2.6881	2.6869	2.5077	2.5013	0.0084	0.0002
40DU60	2 1/2	2 11/16	3.75	2.5011	2.4993	2.6881	2.6869	2.5077	2.5013	0.0084	0.0002
40DU64	2 1/2	2 11/16	4	2.5011	2.4993	2.6881	2.6869	2.5077	2.5013	0.0084	0.0002

SPB INDUSTRIAL CO., LIMITED

Web: <http://www.spboiles.com>

Email: zhou@spboiles.com

40DU72	2 1/2	2 11/16	4.5	2.5011	2.4993	2.6881	2.6869	2.5077	2.5013	0.0084	0.0002
40DU76	2 1/2	2 11/16	4.75	2.5011	2.4993	2.6881	2.6869	2.5077	2.5013	0.0084	0.0002
44DU32	2 3/4	2 15/16	2	2.75	2.7482	2.937	2.9358	2.7566	2.7502	0.0084	0.0002
44DU36	2 3/4	2 15/16	2.25	2.75	2.7482	2.937	2.9358	2.7566	2.7502	0.0084	0.0002
44DU40	2 3/4	2 15/16	2.5	2.75	2.7482	2.937	2.9358	2.7566	2.7502	0.0084	0.0002
44DU48	2 3/4	2 15/16	3	2.75	2.7482	2.937	2.9358	2.7566	2.7502	0.0084	0.0002
44DU56	2 3/4	2 15/16	3.5	2.75	2.7482	2.937	2.9358	2.7566	2.7502	0.0084	0.0002
44DU60	2 3/4	2 15/16	3.75	2.75	2.7482	2.937	2.9358	2.7566	2.7502	0.0084	0.0002
44DU64	2 3/4	2 15/16	4	2.75	2.7482	2.937	2.9358	2.7566	2.7502	0.0084	0.0002
44DU72	2 3/4	2 15/16	4.5	2.75	2.7482	2.937	2.9358	2.7566	2.7502	0.0084	0.0002
44DU76	2 3/4	2 15/16	4.75	2.75	2.7482	2.937	2.9358	2.7566	2.7502	0.0084	0.0002
44DU80	2 3/4	2 15/16	5	2.75	2.7482	2.937	2.9358	2.7566	2.7502	0.0084	0.0002
48DU32	3	3 3/16	2	3	2.9982	3.1872	3.1858	3.0068	3.0002	0.0086	0.0002
48DU36	3	3 3/16	2.25	3	2.9982	3.1872	3.1858	3.0068	3.0002	0.0086	0.0002
48DU40	3	3 3/16	2.5	3	2.9982	3.1872	3.1858	3.0068	3.0002	0.0086	0.0002
48DU48	3	3 3/16	3	3	2.9982	3.1872	3.1858	3.0068	3.0002	0.0086	0.0002
48DU56	3	3 3/16	3.5	3	2.9982	3.1872	3.1858	3.0068	3.0002	0.0086	0.0002
48DU60	3	3 3/16	3.75	3	2.9982	3.1872	3.1858	3.0068	3.0002	0.0086	0.0002
48DU64	3	3 3/16	4	3	2.9982	3.1872	3.1858	3.0068	3.0002	0.0086	0.0002
48DU72	3	3 3/16	4.5	3	2.9982	3.1872	3.1858	3.0068	3.0002	0.0086	0.0002
48DU76	3	3 3/16	4.75	3	2.9982	3.1872	3.1858	3.0068	3.0002	0.0086	0.0002
48DU80	3	3 3/16	5	3	2.9982	3.1872	3.1858	3.0068	3.0002	0.0086	0.0002
52DU32	3 1/4	3 7/16	2	3.25	3.248	3.4372	3.4358	3.2568	3.2502	0.0088	0.0002
52DU38	3 1/4	3 7/16	2.375	3.25	3.248	3.4372	3.4358	3.2568	3.2502	0.0088	0.0002
52DU40	3 1/4	3 7/16	2.5	3.25	3.248	3.4372	3.4358	3.2568	3.2502	0.0088	0.0002
52DU48	3 1/4	3 7/16	3	3.25	3.248	3.4372	3.4358	3.2568	3.2502	0.0088	0.0002
52DU56	3 1/4	3 7/16	3.5	3.25	3.248	3.4372	3.4358	3.2568	3.2502	0.0088	0.0002
52DU60	3 1/4	3 7/16	3.75	3.25	3.248	3.4372	3.4358	3.2568	3.2502	0.0088	0.0002
52DU64	3 1/4	3 7/16	4	3.25	3.248	3.4372	3.4358	3.2568	3.2502	0.0088	0.0002
52DU72	3 1/4	3 7/16	4.5	3.25	3.248	3.4372	3.4358	3.2568	3.2502	0.0088	0.0002
52DU76	3 1/4	3 7/16	4.75	3.25	3.248	3.4372	3.4358	3.2568	3.2502	0.0088	0.0002
52DU80	3 1/4	3 7/16	5	3.25	3.248	3.4372	3.4358	3.2568	3.2502	0.0088	0.0002
56DU32	3 1/2	3 11/16	2	3.5	3.4978	3.6872	3.6858	3.5068	3.5002	0.009	0.0002
56DU38	3 1/2	3 11/16	2.375	3.5	3.4978	3.6872	3.6858	3.5068	3.5002	0.009	0.0002
56DU40	3 1/2	3 11/16	2.5	3.5	3.4978	3.6872	3.6858	3.5068	3.5002	0.009	0.0002
56DU48	3 1/2	3 11/16	3	3.5	3.4978	3.6872	3.6858	3.5068	3.5002	0.009	0.0002
56DU56	3 1/2	3 11/16	3.5	3.5	3.4978	3.6872	3.6858	3.5068	3.5002	0.009	0.0002
56DU60	3 1/2	3 11/16	3.75	3.5	3.4978	3.6872	3.6858	3.5068	3.5002	0.009	0.0002
56DU64	3 1/2	3 11/16	4	3.5	3.4978	3.6872	3.6858	3.5068	3.5002	0.009	0.0002
56DU72	3 1/2	3 11/16	4.5	3.5	3.4978	3.6872	3.6858	3.5068	3.5002	0.009	0.0002

SPB INDUSTRIAL CO., LIMITED

Web: <http://www.spboiles.com>

Email: zhou@spboiles.com

56DU76	3 1/2	3 11/16	4.75	3.5	3.4978	3.6872	3.6858	3.5068	3.5002	0.009	0.0002
56DU80	3 1/2	3 11/16	5	3.5	3.4978	3.6872	3.6858	3.5068	3.5002	0.009	0.0002
58DU32	3 5/8	3 13/16	2	3.625	3.6228	3.8122	3.8108	3.6318	3.6252	0.009	0.0002
58DU36	3 5/8	3 13/16	2.25	3.625	3.6228	3.8122	3.8108	3.6318	3.6252	0.009	0.0002
58DU40	3 5/8	3 13/16	2.5	3.625	3.6228	3.8122	3.8108	3.6318	3.6252	0.009	0.0002
58DU48	3 5/8	3 13/16	3	3.625	3.6228	3.8122	3.8108	3.6318	3.6252	0.009	0.0002
58DU56	3 5/8	3 13/16	3.5	3.625	3.6228	3.8122	3.8108	3.6318	3.6252	0.009	0.0002
58DU60	3 5/8	3 13/16	3.75	3.625	3.6228	3.8122	3.8108	3.6318	3.6252	0.009	0.0002
58DU64	3 5/8	3 13/16	4	3.625	3.6228	3.8122	3.8108	3.6318	3.6252	0.009	0.0002
58DU72	3 5/8	3 13/16	4.5	3.625	3.6228	3.8122	3.8108	3.6318	3.6252	0.009	0.0002
58DU76	3 5/8	3 13/16	4.75	3.625	3.6228	3.8122	3.8108	3.6318	3.6252	0.009	0.0002
58DU80	3 5/8	3 13/16	5	3.625	3.6228	3.8122	3.8108	3.6318	3.6252	0.009	0.0002
60DU32	3 3/4	3 15/16	2	3.75	3.7478	3.9372	3.9358	3.7568	3.7502	0.009	0.0002
60DU36	3 3/4	3 15/16	2.25	3.75	3.7478	3.9372	3.9358	3.7568	3.7502	0.009	0.0002
60DU40	3 3/4	3 15/16	2.5	3.75	3.7478	3.9372	3.9358	3.7568	3.7502	0.009	0.0002
60DU48	3 3/4	3 15/16	3	3.75	3.7478	3.9372	3.9358	3.7568	3.7502	0.009	0.0002
60DU56	3 3/4	3 15/16	3.5	3.75	3.7478	3.9372	3.9358	3.7568	3.7502	0.009	0.0002
60DU60	3 3/4	3 15/16	3.75	3.75	3.7478	3.9372	3.9358	3.7568	3.7502	0.009	0.0002
60DU64	3 3/4	3 15/16	4	3.75	3.7478	3.9372	3.9358	3.7568	3.7502	0.009	0.0002
60DU72	3 3/4	3 15/16	4.5	3.75	3.7478	3.9372	3.9358	3.7568	3.7502	0.009	0.0002
60DU76	3 3/4	3 15/16	4.75	3.75	3.7478	3.9372	3.9358	3.7568	3.7502	0.009	0.0002
60DU80	3 3/4	3 15/16	5	3.75	3.7478	3.9372	3.9358	3.7568	3.7502	0.009	0.0002
64DU32	4	4 3/16	2	4	3.9978	4.1872	4.1858	4.0068	4.0002	0.009	0.0002
64DU36	4	4 3/16	2.25	4	3.9978	4.1872	4.1858	4.0068	4.0002	0.009	0.0002
64DU40	4	4 3/16	2.5	4	3.9978	4.1872	4.1858	4.0068	4.0002	0.009	0.0002
64DU48	4	4 3/16	3	4	3.9978	4.1872	4.1858	4.0068	4.0002	0.009	0.0002
64DU56	4	4 3/16	3.5	4	3.9978	4.1872	4.1858	4.0068	4.0002	0.009	0.0002
64DU60	4	4 3/16	3.75	4	3.9978	4.1872	4.1858	4.0068	4.0002	0.009	0.0002
64DU64	4	4 3/16	4	4	3.9978	4.1872	4.1858	4.0068	4.0002	0.009	0.0002
64DU72	4	4 3/16	4.5	4	3.9978	4.1872	4.1858	4.0068	4.0002	0.009	0.0002
64DU76	4	4 3/16	4.75	4	3.9978	4.1872	4.1858	4.0068	4.0002	0.009	0.0002
64DU80	4	4 3/16	5	4	3.9978	4.1872	4.1858	4.0068	4.0002	0.009	0.0002
68DU32	4 1/4	4 7/16	2	4.25	4.2478	4.4372	4.4358	4.2568	4.2502	0.009	0.0002
68DU36	4 1/4	4 7/16	2.25	4.25	4.2478	4.4372	4.4358	4.2568	4.2502	0.009	0.0002
68DU40	4 1/4	4 7/16	2.5	4.25	4.2478	4.4372	4.4358	4.2568	4.2502	0.009	0.0002
68DU48	4 1/4	4 7/16	3	4.25	4.2478	4.4372	4.4358	4.2568	4.2502	0.009	0.0002
68DU56	4 1/4	4 7/16	3.5	4.25	4.2478	4.4372	4.4358	4.2568	4.2502	0.009	0.0002
68DU60	4 1/4	4 7/16	3.75	4.25	4.2478	4.4372	4.4358	4.2568	4.2502	0.009	0.0002
68DU64	4 1/4	4 7/16	4	4.25	4.2478	4.4372	4.4358	4.2568	4.2502	0.009	0.0002
68DU72	4 1/4	4 7/16	4.5	4.25	4.2478	4.4372	4.4358	4.2568	4.2502	0.009	0.0002

SPB INDUSTRIAL CO., LIMITED

Web: <http://www.spboiles.com>

Email: zhou@spboiles.com

68DU76	4 1/4	4 7/16	4.75	4.25	4.2478	4.4372	4.4358	4.2568	4.2502	0.009	0.0002
68DU80	4 1/4	4 7/16	5	4.25	4.2478	4.4372	4.4358	4.2568	4.2502	0.009	0.0002
70DU32	4 3/8	4 9/16	2	4.375	4.3728	4.5622	4.5608	4.3818	4.3752	0.009	0.0002
70DU36	4 3/8	4 9/16	2.25	4.375	4.3728	4.5622	4.5608	4.3818	4.3752	0.009	0.0002
70DU40	4 3/8	4 9/16	2.5	4.375	4.3728	4.5622	4.5608	4.3818	4.3752	0.009	0.0002
70DU48	4 3/8	4 9/16	3	4.375	4.3728	4.5622	4.5608	4.3818	4.3752	0.009	0.0002
70DU56	4 3/8	4 9/16	3.5	4.375	4.3728	4.5622	4.5608	4.3818	4.3752	0.009	0.0002
70DU60	4 3/8	4 9/16	3.75	4.375	4.3728	4.5622	4.5608	4.3818	4.3752	0.009	0.0002
70DU64	4 3/8	4 9/16	4	4.375	4.3728	4.5622	4.5608	4.3818	4.3752	0.009	0.0002
70DU72	4 3/8	4 9/16	4.5	4.375	4.3728	4.5622	4.5608	4.3818	4.3752	0.009	0.0002
70DU76	4 3/8	4 9/16	4.75	4.375	4.3728	4.5622	4.5608	4.3818	4.3752	0.009	0.0002
70DU80	4 3/8	4 9/16	5	4.375	4.3728	4.5622	4.5608	4.3818	4.3752	0.009	0.0002
72DU32	4 1/2	4 11/16	2	4.5	4.4978	4.6872	4.6858	4.5068	4.5002	0.009	0.0002
72DU36	4 1/2	4 11/16	2.25	4.5	4.4978	4.6872	4.6858	4.5068	4.5002	0.009	0.0002
72DU40	4 1/2	4 11/16	2.5	4.5	4.4978	4.6872	4.6858	4.5068	4.5002	0.009	0.0002
72DU48	4 1/2	4 11/16	3	4.5	4.4978	4.6872	4.6858	4.5068	4.5002	0.009	0.0002
72DU56	4 1/2	4 11/16	3.5	4.5	4.4978	4.6872	4.6858	4.5068	4.5002	0.009	0.0002
72DU60	4 1/2	4 11/16	3.75	4.5	4.4978	4.6872	4.6858	4.5068	4.5002	0.009	0.0002
72DU64	4 1/2	4 11/16	4	4.5	4.4978	4.6872	4.6858	4.5068	4.5002	0.009	0.0002
72DU72	4 1/2	4 11/16	4.5	4.5	4.4978	4.6872	4.6858	4.5068	4.5002	0.009	0.0002
72DU76	4 1/2	4 11/16	4.75	4.5	4.4978	4.6872	4.6858	4.5068	4.5002	0.009	0.0002
72DU80	4 1/2	4 11/16	5	4.5	4.4978	4.6872	4.6858	4.5068	4.5002	0.009	0.0002
76DU32	4 3/4	4 15/16	2	4.75	4.7475	4.9374	4.9358	4.7572	4.7502	0.0097	0.0002
76DU36	4 3/4	4 15/16	2.25	4.75	4.7475	4.9374	4.9358	4.7572	4.7502	0.0097	0.0002
76DU40	4 3/4	4 15/16	2.5	4.75	4.7475	4.9374	4.9358	4.7572	4.7502	0.0097	0.0002
76DU48	4 3/4	4 15/16	3	4.75	4.7475	4.9374	4.9358	4.7572	4.7502	0.0097	0.0002
76DU56	4 3/4	4 15/16	3.5	4.75	4.7475	4.9374	4.9358	4.7572	4.7502	0.0097	0.0002
76DU60	4 3/4	4 15/16	3.75	4.75	4.7475	4.9374	4.9358	4.7572	4.7502	0.0097	0.0002
76DU64	4 3/4	4 15/16	4	4.75	4.7475	4.9374	4.9358	4.7572	4.7502	0.0097	0.0002
76DU72	4 3/4	4 15/16	4.5	4.75	4.7475	4.9374	4.9358	4.7572	4.7502	0.0097	0.0002
76DU76	4 3/4	4 15/16	4.75	4.75	4.7475	4.9374	4.9358	4.7572	4.7502	0.0097	0.0002
76DU80	4 3/4	4 15/16	5	4.75	4.7475	4.9374	4.9358	4.7572	4.7502	0.0097	0.0002
80DU32	5	5 3/16	2	4.9986	4.9961	5.186	5.1844	5.0056	4.9988	0.0095	0.0002
80DU36	5	5 3/16	2.25	4.9986	4.9961	5.186	5.1844	5.0056	4.9988	0.0095	0.0002
80DU40	5	5 3/16	2.5	4.9986	4.9961	5.186	5.1844	5.0056	4.9988	0.0095	0.0002
80DU48	5	5 3/16	3	4.9986	4.9961	5.186	5.1844	5.0056	4.9988	0.0095	0.0002
80DU56	5	5 3/16	3.5	4.9986	4.9961	5.186	5.1844	5.0056	4.9988	0.0095	0.0002
80DU60	5	5 3/16	3.75	4.9986	4.9961	5.186	5.1844	5.0056	4.9988	0.0095	0.0002
80DU64	5	5 3/16	4	4.9986	4.9961	5.186	5.1844	5.0056	4.9988	0.0095	0.0002
80DU72	5	5 3/16	4.5	4.9986	4.9961	5.186	5.1844	5.0056	4.9988	0.0095	0.0002

SPB INDUSTRIAL CO., LIMITED

Web: <http://www.spboiles.com>

Email: zhou@spboiles.com

80DU76	5	5 3/16	4.75	4.9986	4.9961	5.186	5.1844	5.0056	4.9988	0.0095	0.0002
80DU80	5	5 3/16	5	4.9986	4.9961	5.186	5.1844	5.0056	4.9988	0.0095	0.0002
84DU32	5 1/4	5 7/16	2	5.25	5.2475	5.4374	5.4358	5.257	5.2502	0.0095	0.0002
84DU36	5 1/4	5 7/16	2.25	5.25	5.2475	5.4374	5.4358	5.257	5.2502	0.0095	0.0002
84DU40	5 1/4	5 7/16	2.5	5.25	5.2475	5.4374	5.4358	5.257	5.2502	0.0095	0.0002
84DU48	5 1/4	5 7/16	3	5.25	5.2475	5.4374	5.4358	5.257	5.2502	0.0095	0.0002
84DU56	5 1/4	5 7/16	3.5	5.25	5.2475	5.4374	5.4358	5.257	5.2502	0.0095	0.0002
84DU60	5 1/4	5 7/16	3.75	5.25	5.2475	5.4374	5.4358	5.257	5.2502	0.0095	0.0002
84DU64	5 1/4	5 7/16	4	5.25	5.2475	5.4374	5.4358	5.257	5.2502	0.0095	0.0002
84DU72	5 1/4	5 7/16	4.5	5.25	5.2475	5.4374	5.4358	5.257	5.2502	0.0095	0.0002
84DU76	5 1/4	5 7/16	4.75	5.25	5.2475	5.4374	5.4358	5.257	5.2502	0.0095	0.0002
84DU80	5 1/4	5 7/16	5	5.25	5.2475	5.4374	5.4358	5.257	5.2502	0.0095	0.0002
88DU32	5 1/2	5 11/16	2	5.5	5.4975	5.6874	5.6858	5.507	5.5002	0.0095	0.0002
88DU36	5 1/2	5 11/16	2.25	5.5	5.4975	5.6874	5.6858	5.507	5.5002	0.0095	0.0002
88DU40	5 1/2	5 11/16	2.5	5.5	5.4975	5.6874	5.6858	5.507	5.5002	0.0095	0.0002
88DU48	5 1/2	5 11/16	3	5.5	5.4975	5.6874	5.6858	5.507	5.5002	0.0095	0.0002
88DU56	5 1/2	5 11/16	3.5	5.5	5.4975	5.6874	5.6858	5.507	5.5002	0.0095	0.0002
88DU60	5 1/2	5 11/16	3.75	5.5	5.4975	5.6874	5.6858	5.507	5.5002	0.0095	0.0002
88DU64	5 1/2	5 11/16	4	5.5	5.4975	5.6874	5.6858	5.507	5.5002	0.0095	0.0002
88DU72	5 1/2	5 11/16	4.5	5.5	5.4975	5.6874	5.6858	5.507	5.5002	0.0095	0.0002
88DU76	5 1/2	5 11/16	4.75	5.5	5.4975	5.6874	5.6858	5.507	5.5002	0.0095	0.0002
88DU80	5 1/2	5 11/16	5	5.5	5.4975	5.6874	5.6858	5.507	5.5002	0.0095	0.0002
92DU32	5 3/4	5 15/16	2	5.75	5.7475	5.9374	5.9358	5.757	5.7502	0.0095	0.0002
92DU36	5 3/4	5 15/16	2.25	5.75	5.7475	5.9374	5.9358	5.757	5.7502	0.0095	0.0002
92DU40	5 3/4	5 15/16	2.5	5.75	5.7475	5.9374	5.9358	5.757	5.7502	0.0095	0.0002
92DU48	5 3/4	5 15/16	3	5.75	5.7475	5.9374	5.9358	5.757	5.7502	0.0095	0.0002
92DU56	5 3/4	5 15/16	3.5	5.75	5.7475	5.9374	5.9358	5.757	5.7502	0.0095	0.0002
92DU60	5 3/4	5 15/16	3.75	5.75	5.7475	5.9374	5.9358	5.757	5.7502	0.0095	0.0002
92DU64	5 3/4	5 15/16	4	5.75	5.7475	5.9374	5.9358	5.757	5.7502	0.0095	0.0002
92DU72	5 3/4	5 15/16	4.5	5.75	5.7475	5.9374	5.9358	5.757	5.7502	0.0095	0.0002
92DU76	5 3/4	5 15/16	4.75	5.75	5.7475	5.9374	5.9358	5.757	5.7502	0.0095	0.0002
92DU80	5 3/4	5 15/16	5	5.75	5.7475	5.9374	5.9358	5.757	5.7502	0.0095	0.0002
96DU32	6	6 3/16	2	6	5.9975	6.1874	6.1858	6.007	6.0002	0.0095	0.0002
96DU36	6	6 3/16	2.25	6	5.9975	6.1874	6.1858	6.007	6.0002	0.0095	0.0002
96DU40	6	6 3/16	2.5	6	5.9975	6.1874	6.1858	6.007	6.0002	0.0095	0.0002
96DU48	6	6 3/16	3	6	5.9975	6.1874	6.1858	6.007	6.0002	0.0095	0.0002
96DU56	6	6 3/16	3.5	6	5.9975	6.1874	6.1858	6.007	6.0002	0.0095	0.0002
96DU60	6	6 3/16	3.75	6	5.9975	6.1874	6.1858	6.007	6.0002	0.0095	0.0002
96DU64	6	6 3/16	4	6	5.9975	6.1874	6.1858	6.007	6.0002	0.0095	0.0002
96DU72	6	6 3/16	4.5	6	5.9975	6.1874	6.1858	6.007	6.0002	0.0095	0.0002

SPB INDUSTRIAL CO., LIMITED

Web: <http://www.spboiles.com>

Email: zhou@spboiles.com

96DU76	6	6 3/16	4.75	6	5.9975	6.1874	6.1858	6.007	6.0002	0.0095	0.0002
96DU80	6	6 3/16	5	6	5.9975	6.1874	6.1858	6.007	6.0002	0.0095	0.0002
100DU32	6 1/4	6 7/16	2	6.25	6.2475	6.4374	6.4358	6.257	6.2502	0.0095	0.0002
100DU36	6 1/4	6 7/16	2.25	6.25	6.2475	6.4374	6.4358	6.257	6.2502	0.0095	0.0002
100DU40	6 1/4	6 7/16	2.5	6.25	6.2475	6.4374	6.4358	6.257	6.2502	0.0095	0.0002
100DU48	6 1/4	6 7/16	3	6.25	6.2475	6.4374	6.4358	6.257	6.2502	0.0095	0.0002
100DU56	6 1/4	6 7/16	3.5	6.25	6.2475	6.4374	6.4358	6.257	6.2502	0.0095	0.0002
100DU60	6 1/4	6 7/16	3.75	6.25	6.2475	6.4374	6.4358	6.257	6.2502	0.0095	0.0002
100DU64	6 1/4	6 7/16	4	6.25	6.2475	6.4374	6.4358	6.257	6.2502	0.0095	0.0002
100DU72	6 1/4	6 7/16	4.5	6.25	6.2475	6.4374	6.4358	6.257	6.2502	0.0095	0.0002
100DU76	6 1/4	6 7/16	4.75	6.25	6.2475	6.4374	6.4358	6.257	6.2502	0.0095	0.0002
100DU80	6 1/4	6 7/16	5	6.25	6.2475	6.4374	6.4358	6.257	6.2502	0.0095	0.0002
104DU32	6 1/2	6 11/16	2	6.5	6.4975	6.6874	6.6858	6.507	6.5002	0.0095	0.0002
104DU36	6 1/2	6 11/16	2.25	6.5	6.4975	6.6874	6.6858	6.507	6.5002	0.0095	0.0002
104DU40	6 1/2	6 11/16	2.5	6.5	6.4975	6.6874	6.6858	6.507	6.5002	0.0095	0.0002
104DU48	6 1/2	6 11/16	3	6.5	6.4975	6.6874	6.6858	6.507	6.5002	0.0095	0.0002
104DU56	6 1/2	6 11/16	3.5	6.5	6.4975	6.6874	6.6858	6.507	6.5002	0.0095	0.0002
104DU60	6 1/2	6 11/16	3.75	6.5	6.4975	6.6874	6.6858	6.507	6.5002	0.0095	0.0002
104DU64	6 1/2	6 11/16	4	6.5	6.4975	6.6874	6.6858	6.507	6.5002	0.0095	0.0002
104DU72	6 1/2	6 11/16	4.5	6.5	6.4975	6.6874	6.6858	6.507	6.5002	0.0095	0.0002
104DU76	6 1/2	6 11/16	4.75	6.5	6.4975	6.6874	6.6858	6.507	6.5002	0.0095	0.0002
104DU80	6 1/2	6 11/16	5	6.5	6.4975	6.6874	6.6858	6.507	6.5002	0.0095	0.0002
108DU32	6 3/4	6 15/16	2	6.75	6.7475	6.9374	6.9358	6.757	6.7502	0.0095	0.0002
108DU36	6 3/4	6 15/16	2.25	6.75	6.7475	6.9374	6.9358	6.757	6.7502	0.0095	0.0002
108DU40	6 3/4	6 15/16	2.5	6.75	6.7475	6.9374	6.9358	6.757	6.7502	0.0095	0.0002
108DU48	6 3/4	6 15/16	3	6.75	6.7475	6.9374	6.9358	6.757	6.7502	0.0095	0.0002
108DU56	6 3/4	6 15/16	3.5	6.75	6.7475	6.9374	6.9358	6.757	6.7502	0.0095	0.0002
108DU60	6 3/4	6 15/16	3.75	6.75	6.7475	6.9374	6.9358	6.757	6.7502	0.0095	0.0002
108DU64	6 3/4	6 15/16	4	6.75	6.7475	6.9374	6.9358	6.757	6.7502	0.0095	0.0002
108DU72	6 3/4	6 15/16	4.5	6.75	6.7475	6.9374	6.9358	6.757	6.7502	0.0095	0.0002
108DU76	6 3/4	6 15/16	4.75	6.75	6.7475	6.9374	6.9358	6.757	6.7502	0.0095	0.0002
108DU80	6 3/4	6 15/16	5	6.75	6.7475	6.9374	6.9358	6.757	6.7502	0.0095	0.0002
112DU32	7	7 3/16	2	6.9954	6.9929	7.183	7.1812	7.0026	6.9956	0.0097	0.0002
112DU36	7	7 3/16	2.25	6.9954	6.9929	7.183	7.1812	7.0026	6.9956	0.0097	0.0002
112DU40	7	7 3/16	2.5	6.9954	6.9929	7.183	7.1812	7.0026	6.9956	0.0097	0.0002
112DU48	7	7 3/16	3	6.9954	6.9929	7.183	7.1812	7.0026	6.9956	0.0097	0.0002
112DU56	7	7 3/16	3.5	6.9954	6.9929	7.183	7.1812	7.0026	6.9956	0.0097	0.0002
112DU60	7	7 3/16	3.75	6.9954	6.9929	7.183	7.1812	7.0026	6.9956	0.0097	0.0002
112DU64	7	7 3/16	4	6.9954	6.9929	7.183	7.1812	7.0026	6.9956	0.0097	0.0002
112DU72	7	7 3/16	4.5	6.9954	6.9929	7.183	7.1812	7.0026	6.9956	0.0097	0.0002

SPB INDUSTRIAL CO.,LIMITED

Web: <http://www.spboiles.com>

Email: zhou@spboiles.com

112DU76	7	7 3/16	4.75	6.9954	6.9929	7.183	7.1812	7.0026	6.9956	0.0097	0.0002
112DU80	7	7 3/16	5	6.9954	6.9929	7.183	7.1812	7.0026	6.9956	0.0097	